

RADIAL FAN

with free-wheeling impeller

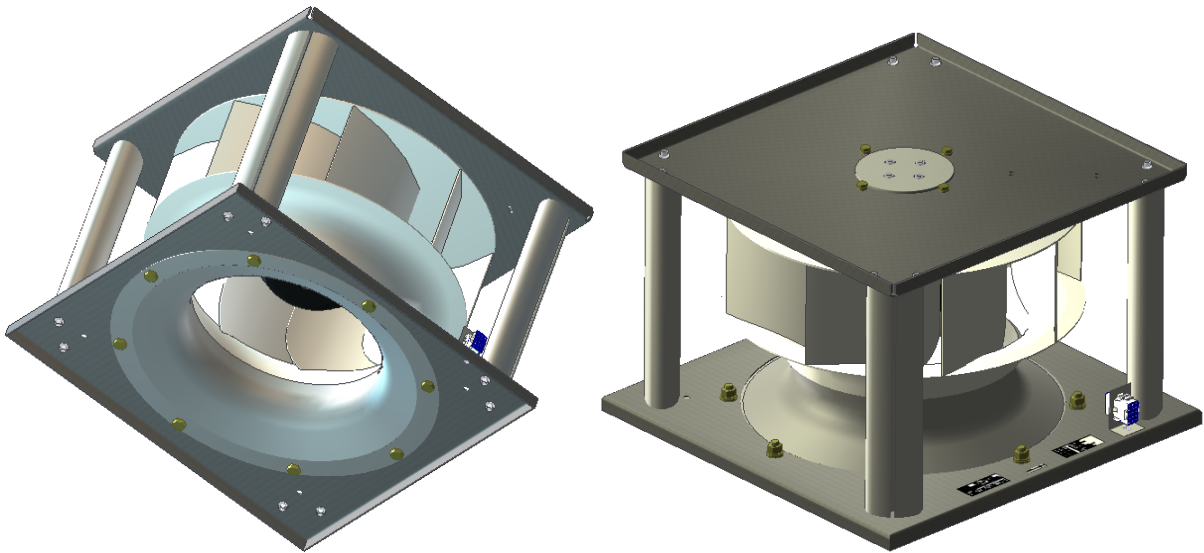

RC-T DKHM 500 -4-SW.155.6HF-021



Gottlieb-Dunkel-Str.20/21
D-12099 Berlin-Tempelhof

Tel.: ++49 - (0)30 - 780 962 0
Fax ++49 - (0)30 - 780 962 28

Internet: www.rc-technik.com
e-m@il: info@rc-technik.com

Product: Radial fan RC-T DKHM 500-4SW-155-6HF,
with free-wheeling impeller

Model: available: - in various RAL colour tones
- with EC motor

Motor
construction type: external rotor motor, three-phase current
Casing: galvanized sheet steel, colour-coated
Impeller wheel: aluminium sheet

All models are supplied with mating connector and transport lugs.

Technical data:

Nominal voltage	500 V (D)
Power frequency	50 Hz
Max. power consumption	1.8 kW
Max. mains current	2.8 A
Volume flow	4000 m ³ /h
Static pressure increase	650 Pa
Rated speed	1380 min ⁻¹
Motor protection type	IP 54; insulation class F
Operating temperature	-25...+60 °C
Weight	40 kg
Expected service life	40,000 hours of operation, at 40 °C ambient temperature as reference value (depending on marginal conditions)
Certifications	CE, VDE

Direction of rotation: clockwise (viewed from rotor)

Direction of movement: inlet on rotor side

Mounting position: rotor axis horizontal or vertical

Connection diagram: wired up on 15-pole connector

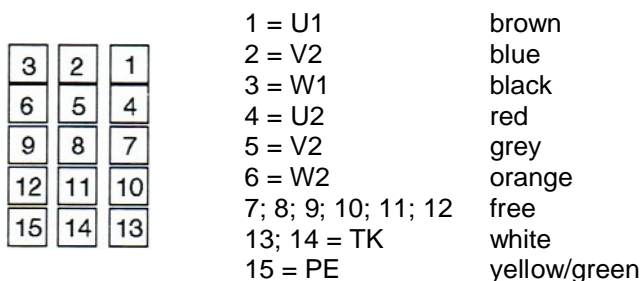

Particularities: The external rotor motor is equipped with thermal contacts which are embedded in the windings. These temperature-dependent circuit elements are monitoring the winding temperature of the motor. If properly connected, the fan is thus protected from overload, mains phase failure, lock-breaking of the motor and too high ambient operating temperatures. Maintenance-free operation is ensured by means of ball-bearings with long-term lubrication which are closed on both sides.

Dimensional drawing:

